

# Dial Totem

## User's Guide



## Notes, cautions, and warnings

 **NOTE:** A NOTE indicates important information that helps you make better use of your product.

 **CAUTION:** A CAUTION indicates either potential damage to hardware or loss of data and tells you how to avoid the problem.

 **WARNING:** A WARNING indicates a potential for property damage, personal injury, or death.

**Copyright © 2017 Dell Inc. or its subsidiaries. All rights reserved.** Dell, EMC, and other trademarks are trademarks of Dell Inc. or its subsidiaries. Other trademarks may be trademarks of their respective owners.

# Contents

<b>1 Dial Totem.....</b>	<b>4</b>
<b>2 Dial totem features.....</b>	<b>5</b>
<b>3 Required software.....</b>	<b>6</b>
<b>4 User interactions.....</b>	<b>7</b>
Using the Dial Totem.....	7
Accessing the top-level menu.....	7
<b>5 Customizing the Dial Totem.....</b>	<b>8</b>
<b>6 Maintenance of the Dial Totem.....</b>	<b>10</b>



# Dial Totem

The Dial totem is an on-screen input device that can be used to control system or application-specific interactions on the Dell Canvas. You can use the totem in your non-dominant hand while using the pen or touch with the other hand. You can customize the totem through the **Windows Wheel Settings** page.

## Dial totem features

The Dial totem includes a button [1].



You can either press and hold or do a single click on the button to interact with the Dell Canvas screen [1]. For more information on these interactions, see [user interactions](#).



## Required software

The Dial totem only requires the Microsoft Windows 10 Anniversary version 1607 update or later to function.

You can also download other applications from the Microsoft store for an enhanced user experience with the Dial totem.

## User interactions

The Dial totem supports the gestures as listed in the table.

**Table 1. Dial totem user interactions**

User action	Description
Press and hold	This action activates and shows the Dial totem main menu, there is no app functionality associated with this gesture.
Rotate	The Dial totem is primarily designed to support rotation for interactions that involve changing the values or scrolls through a menu of items. The device can be rotated both clockwise and counterclockwise.
Single click	Clicking the Dial totem is similar to clicking the left mouse button. You can click the totem to select a menu item.
Lift-off—remove the totem from the screen	Lift-off indicates the action of removing the totem from the screen. <ul style="list-style-type: none"> <li>• If the master menu is up and no selection is made, the menu shrinks to the location where the totem was last located. The menu can be moved to a new location by dragging in the center of the wheel.</li> <li>• A selection is made and there is no menu around the totem.</li> <li>• If a selection is made and there is a sublevel menu around the totem, then the sublevel menu shrinks down and moves to the last location where the sublevel menu was last placed.</li> </ul>

## Using the Dial Totem

You can use the Dial totem to access and change the menu settings. The Dial totem must be used in the active area of the Dell Canvas screen. It has no electronics and cannot be used off-screen or even on-screen in the bezel. The Dial totem operates through touch interaction. When you stop touching the totem, the touch interaction discontinues and the totem menu disappears.

## Accessing the top-level menu

You can use the press and hold gesture to access the top level menu.

- 1 To activate the top-level menu, press and hold the totem on the active area of the Dell Canvas screen.
- 2 Once the top-level menu appears, you can release the press, but should continue to hold the totem on the screen. You can navigate the menu by twisting the totem to either the left or right.
- 3 To make a selection or enter a submenu, click the totem when that option or submenu is highlighted.
- 4 Navigate through the available choices within a submenu through subsequent clicks. Twisting to the left and right changes the menu selection dynamically.
- 5 Press and hold again to navigate back to the main menu.



# Customizing the Dial Totem

The Dial totem is integrated with the Windows operating system and supports a set of built-in functions by default. The availability of the function depends on the system state and context when the tools menu is activated. For example, you see the screen brightness tool only when you are connected to a host system with an integrated display such as a notebook computer. You see the scroll option only when you have an active window selected that supports that feature.

Go to **Settings > Devices > Wheel** in the Windows control panel and customize the settings for the Dial totem.

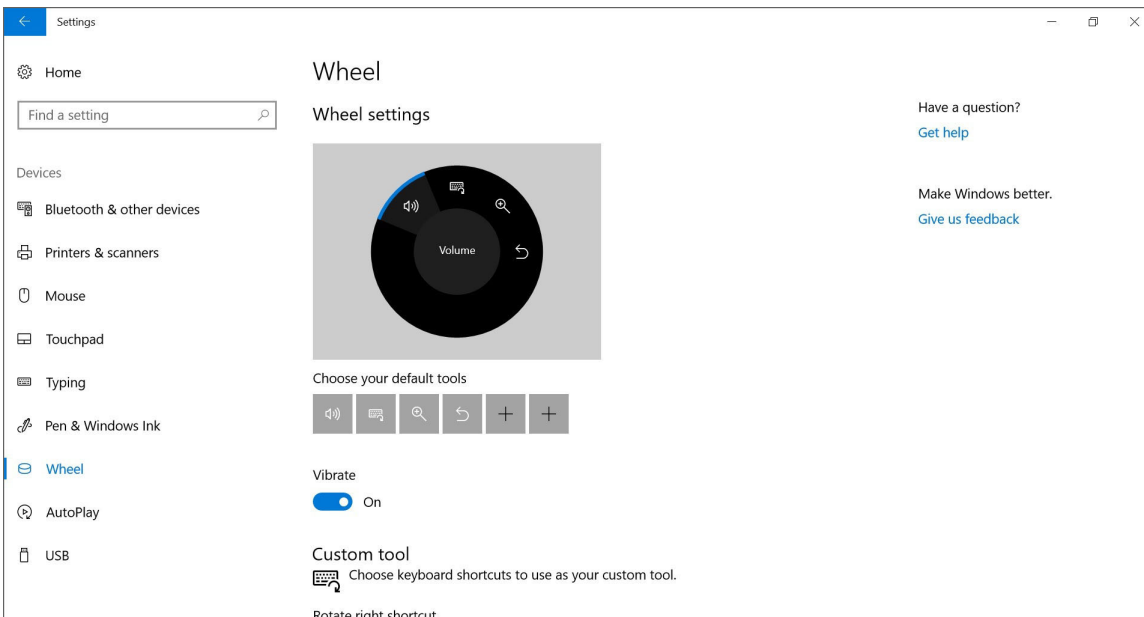

You can choose the required tool from your default tool list and add it to the **Wheel settings**.

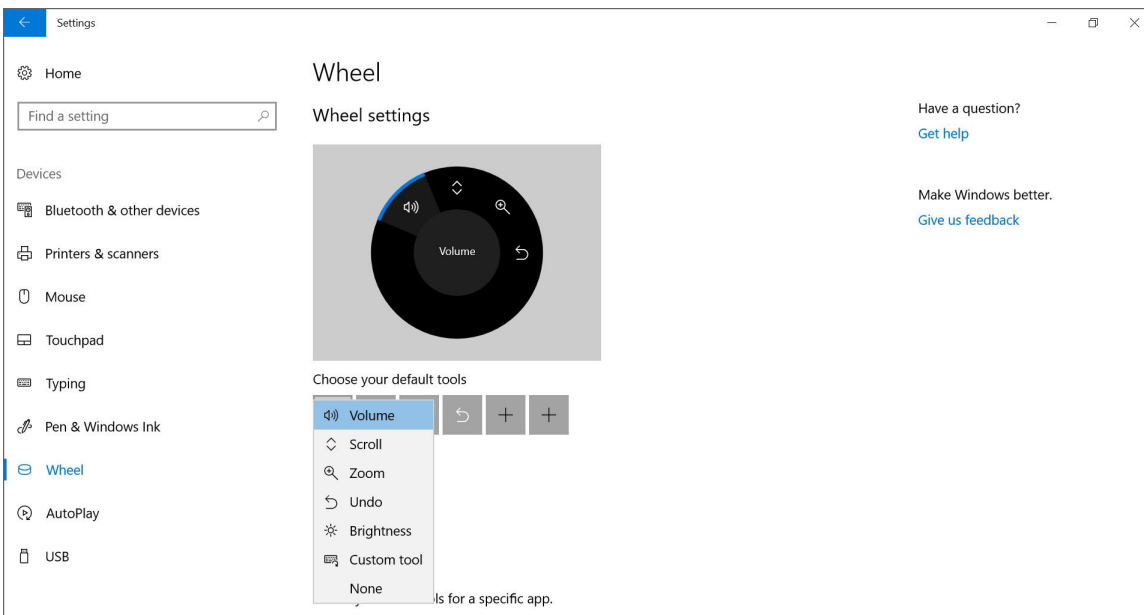

The **Custom tool** option allows you to assign keyboard shortcuts to rotate right, rotate left, and button click.

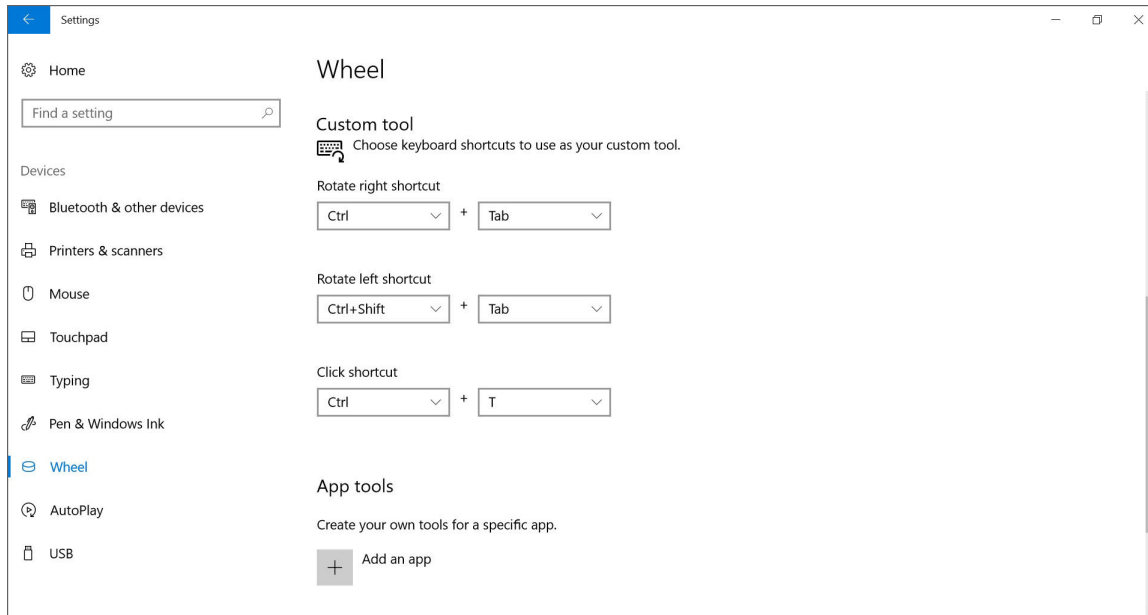

The **App tools** option allows you to add tools specific to a given application such that when that application window is active, the custom tool is available on the menu. Example: Add an application like notepad.

The **Handedness** option allows you to identify which hand you can use with the pen in the **Pen & Windows Ink settings**. Assigning a hand to use the Pen will automatically mean that you will use the totem with the opposite hand. For example, if you use the pen with the right hand, then it is assumed you will use the totem in the left hand, and accidental touches are filtered based on this assumption.

### App tools

Create your own tools for a specific app.

 Add an app

### Handedness

Use the wheel with your right hand and the pen with your left hand

[Change this in Pen & Windows Ink settings](#)

## Maintenance of the Dial Totem

To maintain proper functionality of the Dial totem, ensure that the following set of instructions are followed:

- Do not slide the totem from the bezel onto the active area of the display screen. Always ensure that you lift the totem and then place it on the screen.
- Do not leave the totem on the screen when not in use, during system start-up, or resuming from sleep.
- Always ensure that you use the totem in an active area of the screen.
- Do not cover the totem with nonconductive material.
- Clean the totem with a damp cloth periodically.
- Order a replacement for the totem if you find it damaged to avoid scratching the screen surface.
- Move the totem to another area of the screen if a touch or pen target is located near the totem.